

## LPMS 300

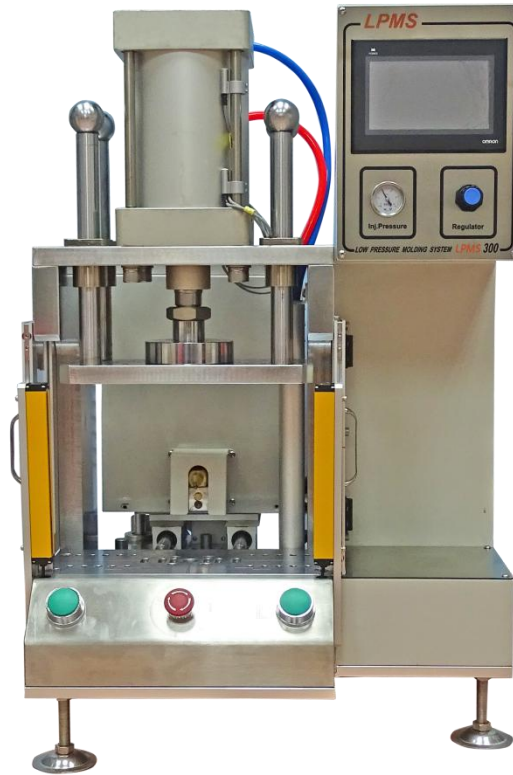

### Side Injection Table Top Compact Machine

LPMS® machines are engineered for low pressure molding, using specialty resins to encapsulate delicate parts, like automotive electronics, PCBA, coil, fiber-optic, LED lighting, cable, etc.

The benefits of side injection is that when one large cavity being encapsulated from the center of the mold, which can prevent the gate mark from the center of product.

## Features

- Intuitive touch screen operation.
- 7 liter melting tank integrated into machine without hose.
- LPMS specially designed melt-on-demand tank can melt down the resin swiftly and evenly.
- The gear pump is made of hard-wearing material , which is stable , maximum shot size is 5g/s.
- Injection pressure range 1~50kg, which can be controlled by the pneumatic safety valve. LPMS also have option like electronic safety valve, which means the injection pressure can be set more precisely from the PLC.
- Over temperature alarm and automatic heating stop functions.
- Safety light curtain and two safety buttons protect workers during the operation.
- Ejection system.

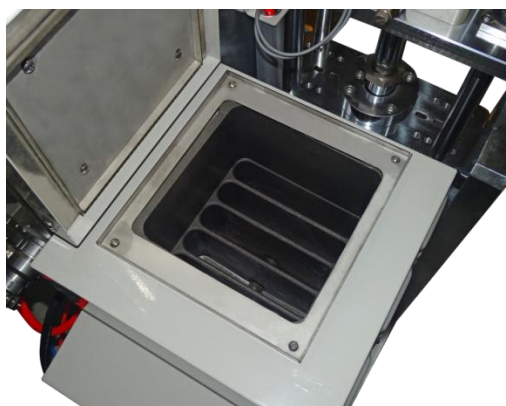

Melting tank

## Specification

Machine Size / Weight	740 mm x 950 mm x 960 mm / 270 kg 29.13 in x 37.40 in x 37.79 in / 595 lbs
Working Station Height	Option
Melting Tank	Melt on demand 7 liter x 1
Auto Feeding System	Optional
Maximum shot size	5.8 g / RPM
Injection rate	5 grams / second
Gun Model & Tip	LPMS-G02 x 1 / 36.4° or 90°
Heated Hose	N/A
Electricity <sup>1</sup>	200-240VAC / 1 Phase / 50 Hz
Temperature Control Zones	2
Temperature Range	Ambient up to 250°C / 485°F
Max. Power	5 Kw
Pump Motor	120 W
Min. Air Pressure	0.5 MPa   73 Psi
Air Consumption	0.1m <sup>3</sup> / min   3.5ft <sup>3</sup> / min
Clamping	Air Cylinder
Clamping Force	1.2 Tons
Clamping Stroke	125mm (Option 150 mm) Std.4.92 in (Option 5.91 in)
Ejector	Air Cylinder
Ejector Force	980 N
Ejector Stroke	10 mm   0.39 in
Control System	7" HMI , PLC controlled
Safety Protection	Light curtain , Emergency stop button
Mold Set Size	180 mm x 100 mm x 150 mm / 16 kg 7.09 in x 3.94 in x 5.91 in / 35.27 lbs
Max. Mold Set Size	250 mm x 120 mm x 150 mm 9.84 in x 4.72 in x 5.91 in

<sup>1</sup> Input power of 200-240 VAC 50/60 Hz single-phase or 380VAC 50 / 60Hz three phase.

Dimension

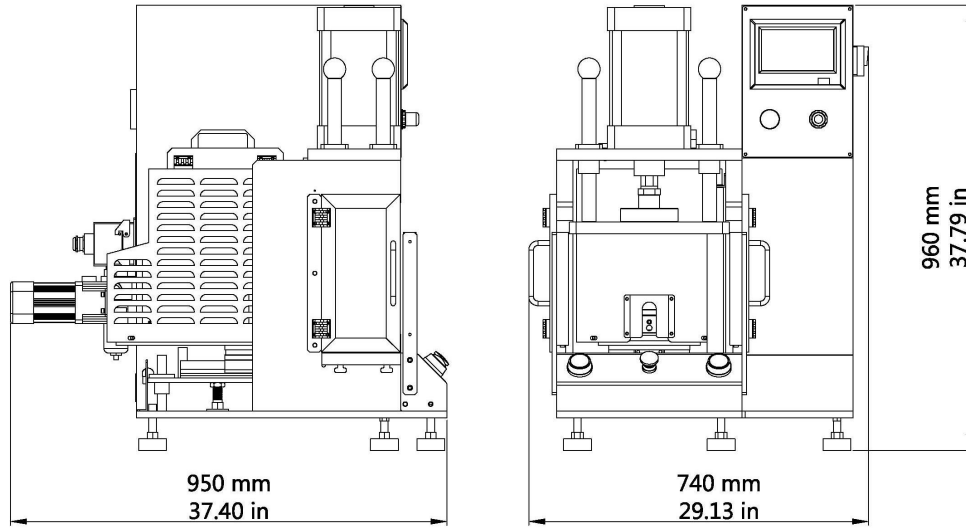

Machine dimension

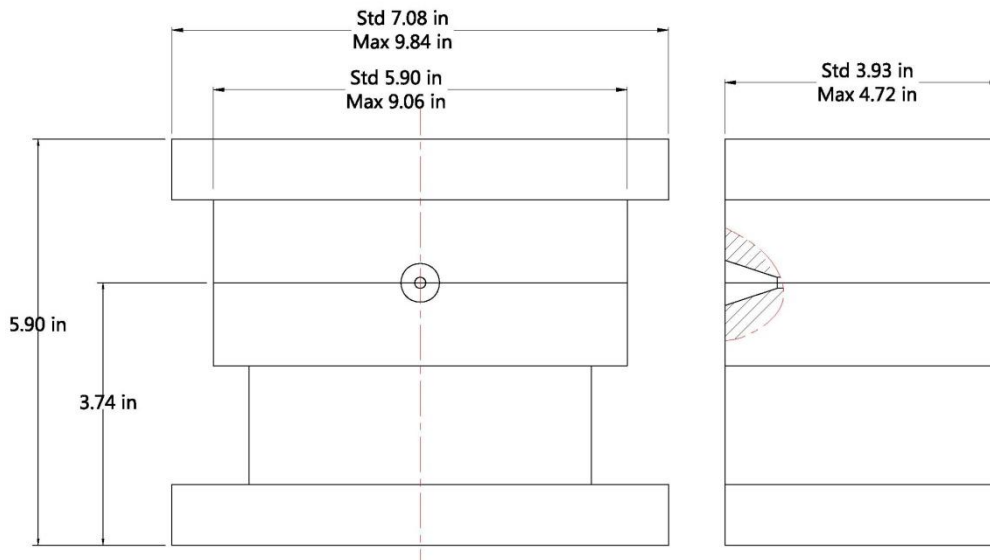

Mold set dimension

※ LPMS reserved the right of final explanation. Please forgive that if any change of products will not specify additionally.